

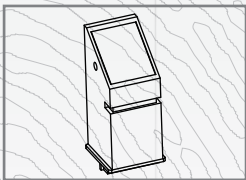

## Seamless integration with your access control system

T5 is an innovative fingerprint card access reader which fully integrates fingerprint and RF technology. The compact design makes it suitable for installation on door frame. T5 has standard Wiegand output to connect seamlessly with access controllers. T5 can easily update the existing card readers for higher security level of fingerprint and card.



Advanced waterproof, dustproof, scratchproof fingerprint sensor



USA TI Digital Signal Processor



Compact design

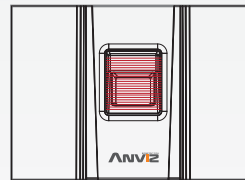

Infrared auto wakeup

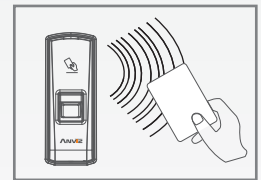

Inbuilt Taiwan EM RFID card reader

## Parameter

Processor	32-bit high speed DSP
Identification Method	FP, Card, FP+Card
Identification Time	≤1 second
Registration Method	Fingerprint, card
User Capacity	512
Record Capacity	32000
Card Reader Module	ID, Mifare , HID(optional)
FRR	0.001%
FAR	0.00001%

Output	Wiegand26/32/34/40 , ANVIZ Wiegand
Communication	RS232, RS485 , MINI USB
Power Supply	Input 12VDC, 300mA
Working Temperature	-10°C-60°C
Size	55(w)*145(h)*37(d)mm
Color	Silver, Black (customizable)
Scan Area	22mm*18mm
Resolution	500DPI
Casing Material	ABS industrial plastic

## Feature

- Small in size and compact in design. Can be easily installed on doorframe
- New generation fully sealed, waterproof and dustproof fingerprint sensor. BioNano core fingerprint algorithm
- Steady 2007 version algorithm platform for T&A and access control, high performance and reliability
- Identification method: fingerprint, card, fingerprint + card
- RFID , Mifare or HID card module. Compatible with industrial standard
- Fingerprint Storage Capacity: 512
- Easy user enrollment on the unit via Master Card or in the management software on computer
- Communicate with computer via RS232 and RS485, MINI USB
- Standard Wiegand26 output to connect with standard access controller
- Encrypted wiegand output to connect with Anviz simple access controller SC021

## Typical installation



Enterprise



Hotel



Building



Government



Finance company

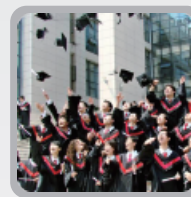

Education and training organization

## Outline drawing

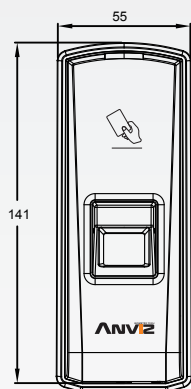

Front view

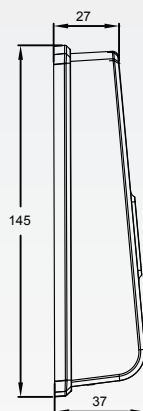

Side view

## Network topology illustration

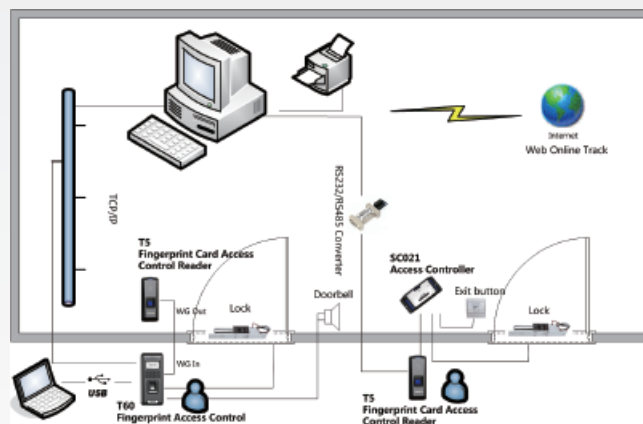

Single door combined/separate type access control solution